

16Kg/Cm²

http://www.yaang.com e-mail: sales@yaang.com

JIS B2220-1984(KSB 1503-1985)

16Kg/Cm² SLIP-ON WELDING STEEL PIPE FLANGES

NOMINAL SIZE 10-600mm

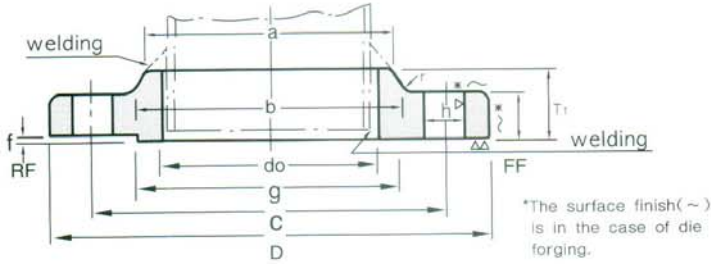

NOMINAL SIZE 650-1200mm

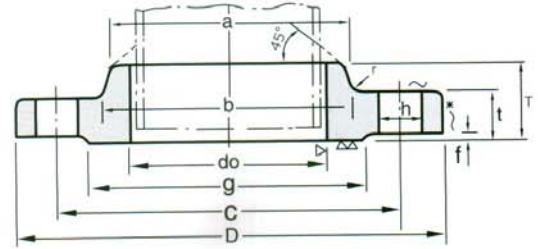

Unit:mm

Nominal Diameter of Flange	Outside Diameter of Steel Pipe	Inside Diameter of Flange do	Sectional Dimensions of Flange								Bolt Hole			Nominal Bolt Size	Weight(Kg)		
			Outside Diameter of Flange D	t	T	Diam. of Hub		Radius r	f	g	Bolt Circle Diameter C	Number of Bolt Holes	Hole Diameter h		SOP	BL	SOH
						a	b										
10	17.3	17.8	90	12	16	26	28	4	1	46	65	4	15	M12	0.52	0.54	0.52
15	21.7	22.2	95	12	16	30	32	4	1	51	70	4	15	M12	0.57	0.61	0.58
20	27.2	27.7	100	14	20	38	42	4	1	56	75	4	15	M12	0.73	0.79	0.75
25	34.0	34.5	125	14	20	46	50	4	1	67	90	4	19	M16	1.13	1.24	1.16
32	42.7	43.2	135	16	22	56	60	5	2	76	100	4	19	M16	1.48	1.66	1.53
40	48.6	49.1	140	16	24	62	66	5	2	81	105	4	19	M16	1.56	1.81	1.64
50	60.5	61.1	155	16	24	76	80	5	2	96	120	8	19	M16	1.8	2.3	1.83
65	76.3	77.1	175	18	26	94	98	5	2	116	140	8	19	M16	2.5	3.1	2.58
80	89.1	90.0	200	20	28	108	112	6	2	132	160	8	23	M20	3.5	4.5	3.66
(90)	101.6	102.6	210	20	30	120	124	6	2	145	170	8	23	M20	3.7	5.0	3.95
100	114.3	115.4	225	22	34	134	138	6	2	160	185	8	23	M20	4.5	6.3	4.94
125	139.8	141.2	270	22	34	164	170	6	2	195	225	8	25	M22	6.5	9.2	7.0
150	165.2	166.6	305	24	38	196	202	6	2	230	260	12	25	M22	8.7	12.8	9.62
200	216.3	218.0	350	26	40	244	252	6	2	275	305	12	25	M22	10.9	18.6	12.1
250	267.4	269.5	430	28	44	304	312	6	2	345	380	12	27	M24	18.0	30.6	20.0
300	318.5	321.0	480	30	48	354	364	8	3	395	430	16	27	M24	21.5	40.7	24.4
350	355.6	358.1	540	34	52	398	408	8	3	440	480	16	33	M30×3	30.8	57.8	35.0
400	406.4	409.0	605	38	60	446	456	10	3	495	540	16	33	M30×3	42.8	82.2	46.2
450	457.2	460.0	675	40	64	504	514	10	3	560	605	20	33	M30×3	55.1	107.6	61.9
500	508.0	511.0	730	42	68	558	568	10	3	615	660	20	33	M30×3	65.1	133.1	73.25
(550)	558.8	562.0	795	44	70	612	622	10	3	670	720	20	39	M36×3	77.9	164.1	88.1
600	609.6	613.0	845	46	74	666	676	10	3	720	770	24	39	M36×3	86.0	193.2	98.8
(650)	660.4	664	895	48	77	704	726	10	5	770	820	24	39	M36×3	96.3	227.5	101.0
700	711.2	715	960	50	80	754	776	10	5	820	875	24	42	M39×3	114.1	272.6	120.0
(750)	762.0	766	1020	52	83	806	832	10	5	880	935	24	42	M39×3	132.7	321.9	141.0
800	812.8	817	1085	54	86	865	885	10	5	930	990	24	48	M45×3	152.1	375.6	161.0
(850)	863.6	868	1135	56	89	916	936	10	5	980	1040	24	48	M45×3	166.5	428.1	177.0
900	914.4	919	1185	58	93	968	986	10	5	1030	1090	28	48	M45×3	178.1	481.8	191.0
1000	1016.0	1021	1320	62	99	1070	1098	12	5	1140	1210	28	56	M52×3	235.3	636.0	230.0
1100	1117.6	1123	1420	66	105	1180	1200	12	5	1240	1310	32	56	M52×3	267.9	784.0	289.0
1200	1219.2	1225	1530	70	112	1282	1302	12	5	1350	1420	32	56	M52×3	321.1	972.4	348.0
1300	1320.8	1326.0	1645	74	-	-	-	-	5	1450	1530	32	62		378.6	1185.2	-
1350	1371.6	1377.0	1700	76	-	-	-	-	5	1510	1590	32	62		410.0	1303.8	-
1400	1422.4	1428.0	1755	78	-	-	-	-	5	1560	1640	36	62		436.0	1422.5	-
1500	1524.0	1529.0	1865	80	-	-	-	-	5	1670	1750	36	62		496.4	1656.6	-

REMARKS:1. Flanges of parenthesized nominal diameter had better not be used.

2. For dimensional tolerance, refer to JIS B2203.

3. In principle material shall be SS400 specified in JIS G3101, SF390A(or SF440A) specified in JIS G3201, or S20C(or S25C) specified in JIS G4051, and shall be fit for welding.